

## The Belden<sup>®</sup> Wireless Solution

Wireless Design Aid  
For IEEE 802.11 a/b/g Networks

**Our Channel Blanket Architecture makes planning of a wireless network easier!**

Use guidelines like the Telecommunications Industry Association (TIA) “TSB-162 Telecommunications Cabling Guidelines for Wireless Access Points”.

Plan based on optimum coverage and throughput, using easy grid references, instead of complex cell planning. It’s as easy as 1-2-3!

**1. Obtain a Floor Plan**

**2. Decide on Desired Coverage**

**3. Deploy the Access Points**

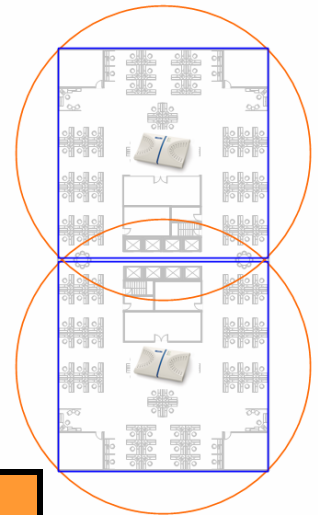
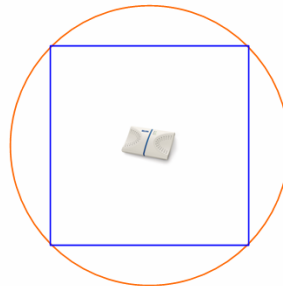
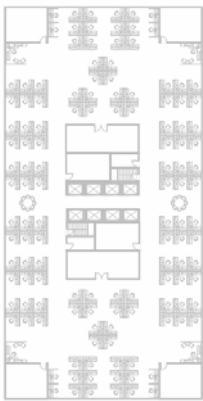

**BWS-8024 24 Port Switch**



**BWS-8008 8 Port Switch**

**Budgetary Ranges and Grid Sizes for Target Data Rate**

	802.11a 54 Mbps	802.11a 36 Mbps	802.11a 18 Mbps	802.11b 11 Mbps	802.11g 54 Mbps	802.11g 36 Mbps	802.11g 11 Mbps
Radius (m) <sup>a</sup>	7	12 <sup>c</sup>	18	35 <sup>c</sup>	12	20 <sup>c</sup>	36
Grid Size (m)	10	17 <sup>c</sup>	25.5	50 <sup>c</sup>	17	28.5 <sup>c</sup>	57
Area <sup>b</sup> (m <sup>2</sup> /ft <sup>2</sup> )	100 1000	290 <sup>c</sup> 2900 <sup>c</sup>	650 6500	2500 <sup>c</sup> 25000 <sup>c</sup>	275 2750	800 <sup>c</sup> 8000 <sup>c</sup>	3200 32000

**BWAP-200 XtraThin AP**



**BWMB-100 Mounting Bracket (Optional)**

**Notes:**

- A) Radius is for planning purposes only and must be verified, it is based on the disturbances found in a typical office environment.
- B) Area is based on the gross area of a square within the radius coverage - this provides for coverage overlap of up to 50% depending on configuration.
- C) The values given in the **red columns** are suggested guidelines based on an optimization between coverage and throughput.